



STAINLESS STEEL
DROP-IN SINKS
One Compartment

For Hand Sink Use!
Includes Gooseneck Faucet & Drain



DI-1-5



DI-1-5SP



DI-1-10



DI-1-25



DI-1-10SP



DI-1-35

**New 6"
Rear & Side
Splash**

FEATURES:

One piece seamless **Deep Drawn** sink bowl design.

All sink bowls have a large liberal radii with a minimum dimension of 2" and are rectangular in design for increased capacity.

Self-Rim Design. Mounting hardware is provided. For counters over 7/8" and up to 1-1/2" thick, please order Thick-Counter Mounting Clips for Drop-In Sinks, **Model # K-28 Per Sink**. (Quantity supplied varies based on drop in sink ordered).

Includes 4" O.C. **K-52** faucet & basket drain.

CONSTRUCTION:

Unit fabricated from one sheet of stainless steel.

All bowls are Sound Deadened.

Units feature Advance Tabco's **Smart Finish™**.

MECHANICAL:

Faucet supply is 1/2" IPS male thread.

Deck mounted faucet is furnished with aerator and 4" O.C.

MATERIAL:

20 gauge type 304 series stainless steel.

Faucets are brass-nickel plated.

Stainless Steel 1-1/2" IPS basket drain.

Available Faucets & Accessories	Model #	Qty
Deck Mounted 3 1/2" Gooseneck. 4" O.C.	K-52	
Deck Mounted 8 1/2" Gooseneck. 4" O.C.	K-55	
Deck Mounted Swing w/Spray. 8" O.C.*	K-58	
Deck Mtd. X.H.D. 3 1/2" Gooseneck. 4" O.C.	K-62	
Thick-Counter Mounting Clips for Countertops over 7/8" and up to 2". (Qty. supplied varies based on sink ordered)	K-28	

*REQUIRES **K-472** FAUCET HOLE REVISION

**FOR REPLACEMENT FAUCET, DRAINS
AND ACCESSORIES, SEE SECTION G**

Standard
Mounting Clips
For Countertops
7/8" Thick or Less
(Included)



K-28 (Per Sink)
Mounting Clips
For Countertops
Over 7/8" Thick
(Maximum of 1 1/2")



NEW YORK
(800) 645-3166
Fax: (631) 242-6900

GEORGIA
(800) 832-1218
Fax: (770) 775-5625

TEXAS
(800) 527-0353
Fax: (972) 932-4795

NEVADA
(800) 446-8684
Fax: (775) 972-1578

DIMENSIONS and SPECIFICATIONS

TOL $\pm .125"$

Supplied with K-52 Faucet

ALL DIMENSIONS ARE TYPICAL

DI-1-5

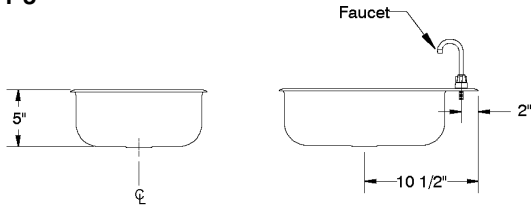

Approx. Wt. 12 lbs.

NSF

DI-1-5SP

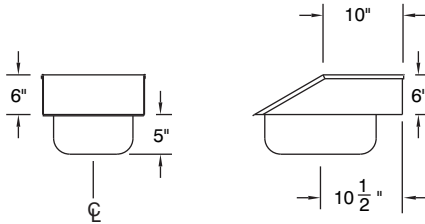

Approx. Wt. 16 lbs.

NSF

DI-1-10

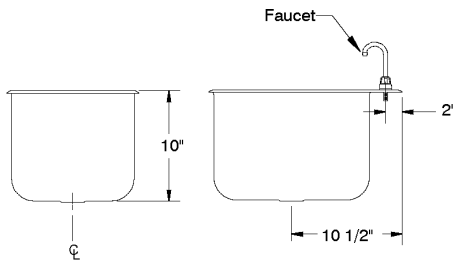

Approx. Wt. 14 lbs.

NSF

DI-1-10SP

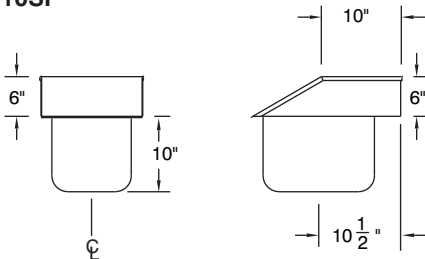

Approx. Wt. 18 lbs.

NSF

TOP VIEW FOR
DI-1-5 & DI-1-10

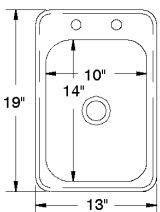

Cut-Out Size
12 1/4" x 18 1/4"
1 1/4" radius corners

TOP VIEW FOR
DI-1-5SP & DI-1-10SP

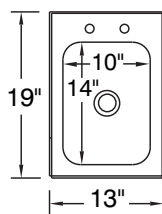

DI-1-25

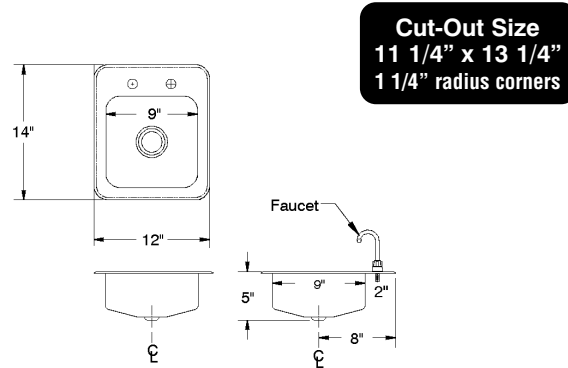

Approx. Wt. 8 lbs.

NSF

DI-1-35

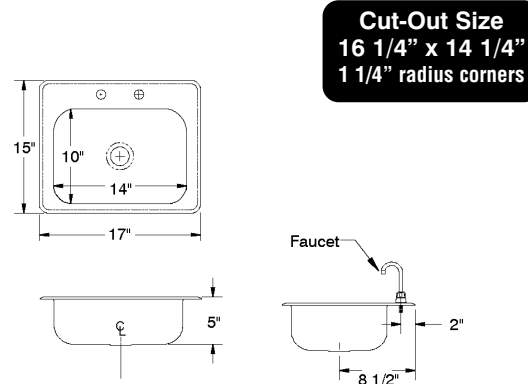

Approx. Wt. 10 lbs.

NSF

TYPICAL INSTALLATION

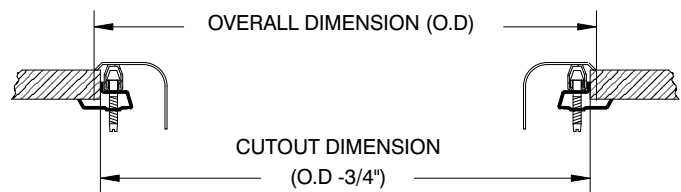

Cut-Out Size = L to R x F to B

